

SPORTY'S®
TOOL SHOP™

HOME • LAWN • GARDEN • GARAGE • ORGANIZATON

SportysToolShop.com

Hardware & Instructions for STEERABLE HOSE REEL CART

Component	Description	Quantity
A	M8 x 120mm bolt with washers and nut	1
B	M6 x 35mm bolt with washers and nut	2
C	M8 x 25mm bolt with washers and nut	4
D	M6 x 45mm bolt with washers and nut	4
E	M16 washer	5
F	Plastic coupling	1
G	Cotter Pins	5
H	Bearing in bucket	1
I	Tape and Rubber Washers	

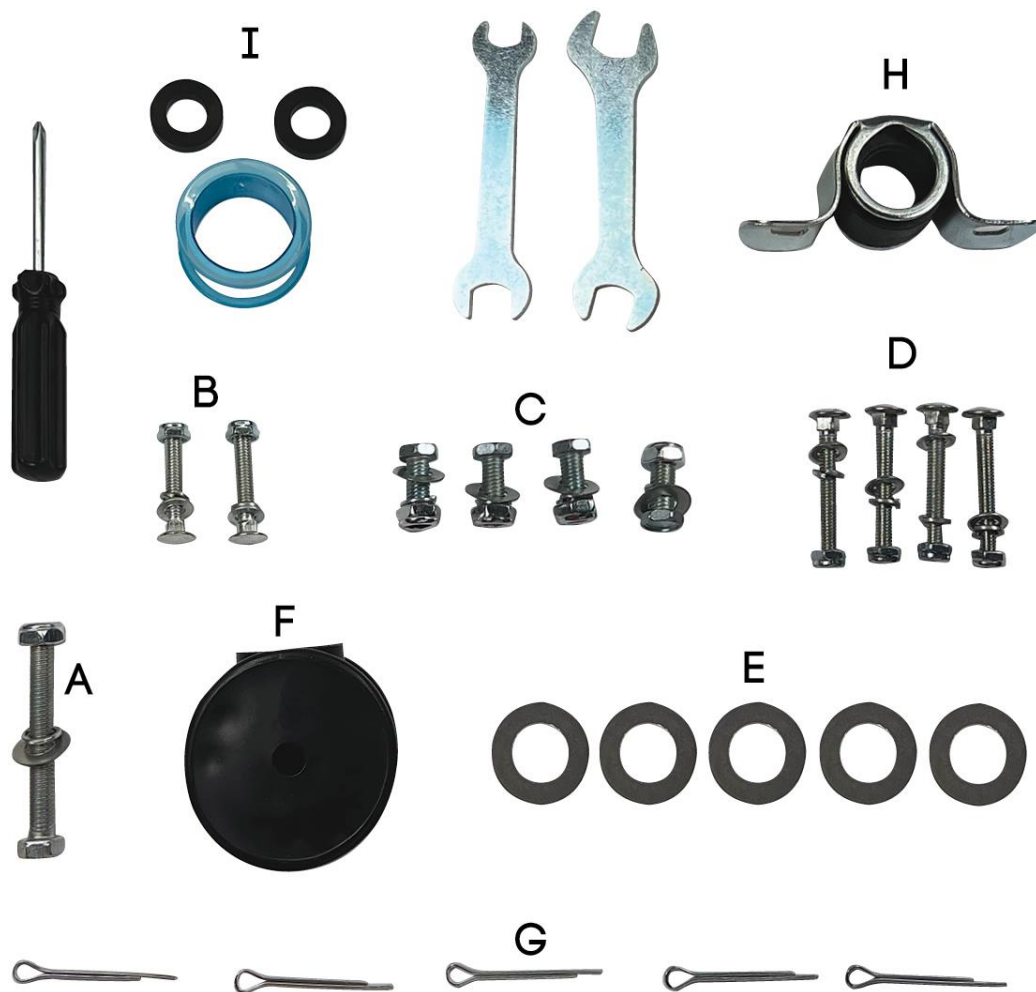

IMPORTANT SAFETY INSTRUCTIONS

1. This Steerable Hose Reel Cart holds up to 230' of 5/8" garden hose.
2. Do not use this Steerable Hose Reel Cart if any part is broken or damaged.
3. This Steerable Hose Reel Cart is not a toy, do not let children use it.
4. Do not inflate tires to more than 30 psi (2.07BAR),
5. Do not modify this Steerable Hose Reel Cart.
6. Do not drink water from this Hose Reel Cart.
7. Always check for damaged or worn-out parts.
8. Drain water out of hose and store inside when not in use.

Assembly:

Step 1. Place basket on frame and front steering assembly under frame. Attach the basket and steering assembly to frame with quantity (2) of Group C hardware.



Pictured above, Step 1 completed.

Step 2. Attach rear bracket assembly to frame and basket using quantity (2) (remaining amount) of hardware from Group C.



Pictured above, Step 2 in progress.



Pictured above, Step 2 completed

Step 3. Attach Steering Linkage to Front Steering Assembly with attached hardware.



Pictured above, Steering Linkage



Pictured above, Support arm from Steering Linkage



Pictured above, attaching Support Arm to front steering assembly.

Step 4. Place tongue of steering linkage to the support post of front steering assembly, use quantity (1) washer from Group E and quantity (1) Group G cotter pin to attach.



Step 5. Slide wheels onto axles and use quantity (1) washer from Group E and quantity (1) cotter pin from Group G to attach.



Step 6. Attach pull handle by using the Plastic Coupling from hardware Group F and hardware from Group A. Then connect the 2-piece handle with attached hardware.



Step 7. Attach Bearing in Bracket from Group H to frame using quantity (2) of Group D hardware.



Step 8. Place barrel on frame and insert crank handle through Bearing in Bracket (Group H) into barrel center. Connect crank handle with hardware Group B.



Pictured above, Crank Handle, Bearing in Bracket, Barrel Center Post



Pictured above, Crank handle inserted through Bearing in Bracket and into the Barrel Center Post



Pictured above, Crank handle and Barrel post connected.

Step 9. Attach opposite end of barrel to frame using quantity (2) of Group D hardware.



Step 10. Apply thread tape from hardware Group I to male hose connector on barrel and leader hose supply.



Step 11. Insert Rubber Washer from Group I into Barrel female water supply connection.



Assembled Steerable Hose Reel Cart



